

# CPH CHALLENGER SERIES PEDESTALS

CPH911, CPH920, CPH1022



Stake  
(S2 Shown)



Bracket  
(B2 Shown)



Lock  
(L00 Shown)



Self-locating  
Cover Security  
Lock Receiver



Winterized Drop  
(A1 Shown)



42" Joint Trench  
Stake (2 per ctn.)  
P/N ST01001

Designed specifically for housing passive equipment, these special versions of the Channell CPH911, CPH920, and CPH1022 pedestals feature direct-bury bases with a high rib design that are less likely to lean or tilt and do not require stakes for installation. A special self-locating cover ensures that the pedestals lock properly without additional alignment. The covers include Channell's Self-Lock<sup>®</sup> security hardware.

## FEATURES

- **9" and 10" diameter round profiles provide maximum workspace and bend radius provisions for all passives, cables and connectors**
- **Round pedestal style maintains a consistent look with legacy pedestals in the field**
- **Constructed of durable, high-strength materials for maximum security and long service life**
- **Universal equipment mounting bracket for passives facilitates installation**
- **Optional stake mounting provision for joint trench or other special applications**

# PART NUMBER MATRIX

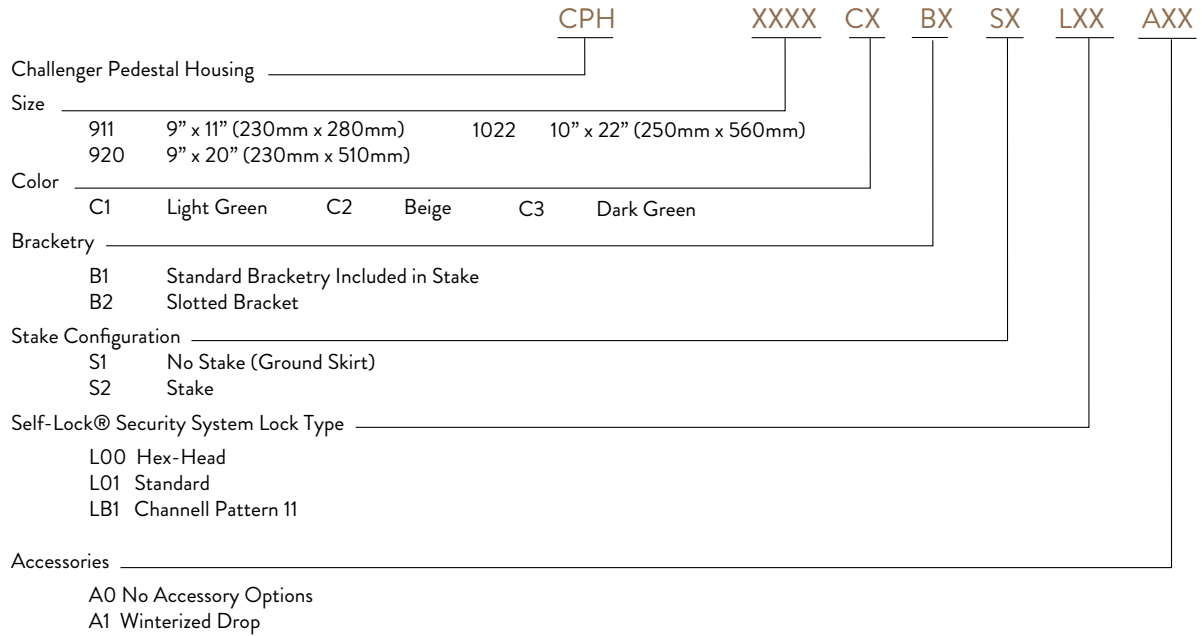

## DIMENSIONS

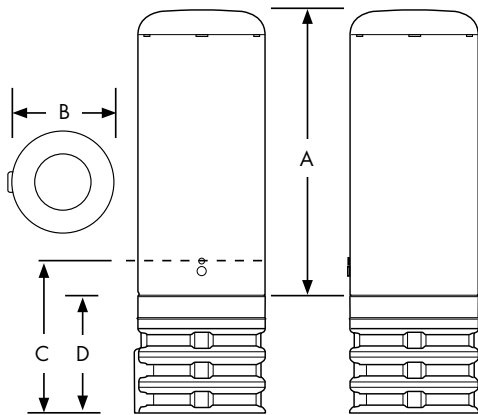

	A	B	C	D
CPH 911	13.0" (330mm)	9.5" (240mm)	14.5" (370mm)	10.5" (265mm)
CPH 920	22.0" (560mm)	9.5" (240mm)	14.5" (370mm)	10.5" (265mm)
CPH 1022	24.0" (610mm)	10.75" (275mm)	14.5" (370mm)	10.5" (265mm)

Note: Dimensions in inches (mm)



## CHANNELL

Where The Industry Connects.

**WORLDWIDE HEADQUARTERS:** Channell Commercial Corporation, Rockwall, TX, United States • Tel 800.423.1863 • Fax 951.296.2322

**CANADA:** Channell Canada, Inc., Mississauga, ON, Canada • Tel 905.565.1700 • Fax 905.565.8282

**EUROPE, MIDDLE EAST, AFRICA:** Channell Ltd., Dartford, United Kingdom • Tel 44.1322.312590 • Fax 44.1322.508490

**AUSTRALIA, ASIA, PACIFIC RIM:** Channell Pty. Ltd., Seven Hills, NSW, Australia • Tel 61.2.8884.4111 • Fax 61.2.8814.8841

**DEVELOPING LOCATION:** Mexico City, D.F., Mexico

[www.channell.com](http://www.channell.com)

All specifications subject to change without notice. © 2020 Channell Commercial Corporation. All rights reserved.