

LFD-200

LIVE FIBER DETECTOR



Allows you to detect traffic and measure signals anywhere on singlemode fibers without having to disconnect them.

KEY FEATURES

No need to open fiber for identification

Hands-free operation via Hold button

Three interchangeable adapter heads

Extended range model: 23 to -50 dBm

SPEC SHEET



Assessing
Next-Gen Networks

NO-DISCONNECTION LIVE FIBER DETECTION

The LFD-200 Live Fiber Detector allows you to detect traffic and measure signals anywhere on singlemode fibers without having to disconnect them. It also lets you check for signal presence before rerouting or maintenance, perform continuity tests and verify cable labeling. Based on non-destructive macrobending technology, the LFD-200 doesn't disrupt traffic, damage or overstress the fiber, enabling efficient, accurate and reliable data acquisition.

Simple Testing of Multiple Fiber Types

EXFO's LFD-200 is the only instrument of its kind on the market that comes with a choice of three built-in, interchangeable adapter heads, making it an all-in-one solution for live fiber detection. The handle's storage compartment holds the extra adapter heads for simple conversion and easy testing of various fiber types.

The LFD-200 also features a unique Hold button that enables hands-free operation. Just slide the button up and over to lock it in place. You are now free to operate your setup.

LFD-201 LFD-202 LFD-202E



Adapter heads compartment (door open)



Ball allowing the adjustment of the compartment door

Adapter heads compartment (door closed)

COMPLETE DIAGNOSIS. FAST.

Simply clamp the LFD-200 onto a fiber, listen for a beep indicating the presence of traffic, then view a complete status report on the multifunction LED display:

- › Signal presence or absence (live or dark fiber)
- › Signal type (customer traffic, continuous or modulated test signal at 270 Hz, 1 kHz or 2 kHz)
- › Signal direction
- › Core power within 2 dB (typical)

LFD-200 SERIES: MODELS AND FEATURES			
	LFD-201	LFD-202	LFD-202E
Core power display		√	√
Maximum power range (dBm)	0 to -40	0 to -40	23 to -50
Over-range indicator		√	√
Fiber type	Single fiber	Single fiber	Single fiber
Fiber heads (included)	3 mm 900 250/RIB	3 mm 900 250/RIB	3 mm 900 250/RIB
Optional 2 mm head	√	√	√
Optional 1.6 mm head			√

Standard Accessories (Interchangeable Heads)

LFD-201, LFD-202 and LFD-202E

3 mm

Extra head for jacketed fiber (3 mm)

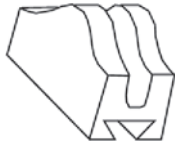

900

Extra head for jacketed fiber (900 mm)

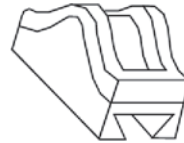

250/RIB

Extra head for coated fiber (250 μm) and ribbon fiber



SPECIFICATIONS

LFD-201, LFD-202 and LFD-202E

Optical Characteristics, Typical

Optical tone receiver	270 Hz, 1 kHz, 2 kHz
Detection technique	Non-destructive macrobending
Loss	< 0.6 dB at 1310 nm
Spectral response	800 nm to 1650 nm
Minimum fiber slack	1.2 cm (1/2 in) required for detection

Core Power Detection, Typical^a

LFD-201	0 dBm to -40 dBm
LFD-202	0 dBm to -40 dBm
LFD-202E	23 dBm to -50 dBm

Fiber Compatibility

Dual window, singlemode	8 µm to 10 µm core diameter
Coating diameter	250 µm diameter
Coating	High refractive index, acrylate

GENERAL SPECIFICATIONS

Size (H x W x D)	236 mm x 30 mm x 32 mm (9 5/16 in x 1 3/16 in x 1 1/4 in)	
Weight	0.3 kg	(0.6 lb)
Battery	Standard 9 V alkaline battery	
Battery life	Approx. 5000 readings	
Temperature		
Operating	-20 °C to 50 °C	(-4 °F to 122 °F)
Storage	-40 °C to 60 °C	(-40 °F to 140 °F)
Humidity	0 % to 90 % non-condensing at 35 °C	

OPTIONAL ACCESSORIES

Optional interchangeable 2 mm head

Optional interchangeable 1.6 mm head

Includes: LFD-200 carrying case, three interchangeable adapter heads, user guide, 9 V alkaline battery and Certificate of Compliance.

Note

a. At 1550 nm.

ORDERING INFORMATION

LFD-20X-X

Live fiber detector

LFD-201 = Standard live fiber detector without core power reading display
 LFD-202 = Live fiber detector with core power reading display
 LFD-202E = Core power reading display (23 dBm to -50 dBm)

Additional heads

00 = No additional heads
 01 = With 2 mm interchangeable head
 02 = With 1.6 mm interchangeable head
 03 = With 2 mm and 1.6 mm interchangeable heads

Example: LFD-201-01

EXFO Corporate Headquarters > 400 Godin Avenue, Quebec City (Quebec) G1M 2K2 CANADA | Tel.: +1 418 683-0211 | Fax: +1 418 683-2170 | info@EXFO.com

Toll-free: +1 800 663-3936 (USA and Canada) | www.EXFO.com

EXFO America	3400 Waterview Parkway, Suite 100 Richardson, TX 75080 USA	Tel.: +1 972 761-9271	Fax: +1 972 761-9067
EXFO Asia	100 Beach Road, #22-01/03 Shaw Tower SINGAPORE 189702	Tel.: +65 6333 8241	Fax: +65 6333 8242
EXFO China	36 North, 3 rd Ring Road East, Dongcheng District Room 1207, Tower C, Global Trade Center Beijing 100013 P. R. CHINA	Tel.: + 86 10 5825 7755	Fax: +86 10 5825 7722
EXFO Europe	Omega Enterprise Park, Electron Way Chandlers Ford, Hampshire S053 4SE ENGLAND	Tel.: +44 23 8024 6810	Fax: +44 23 8024 6801
EXFO NetHawk	Elektronikkatie 2 FI-90590 Oulu, FINLAND	Tel.: +358 (0)403 010 300	Fax: +358 (0)8 564 5203
EXFO Service Assurance	270 Billerica Road Chelmsford, MA 01824 USA	Tel.: +1 978 367-5600	Fax: +1 978 367-5700

EXFO is certified ISO 9001 and attests to the quality of these products. This device complies with Part 15 of the FCC Rules. Operation is subject to the following two conditions: (1) this device may not cause harmful interference, and (2) this device must accept any interference received, including interference that may cause undesired operation. EXFO has made every effort to ensure that the information contained in this specification sheet is accurate. However, we accept no responsibility for any errors or omissions, and we reserve the right to modify design, characteristics and products at any time without obligation. Units of measurement in this document conform to SI standards and practices. In addition, all of EXFO's manufactured products are compliant with the European Union's WEEE directive. For more information, please visit www.EXFO.com/recycle. Contact EXFO for prices and availability or to obtain the phone number of your local EXFO distributor.

For the most recent version of this spec sheet, please go to the EXFO website at www.EXFO.com/specs.

In case of discrepancy, the Web version takes precedence over any printed literature.